

UNI-JET 75 CARENATO

UNI-JET 75 WITH BOX

UNI-JET 75 CAPOTE

UNI-JET 75 MIT GEHÄUSE

UNI-JET 75 CARENADO

- MANUALE ISTRUZIONI
- INSTRUCTIONS HANDBOOK
- MANUEL D'INSTRUCTIONS
- GEBRAUCHSANWEISUNG
- MANUAL DE INSTRUCCIONES

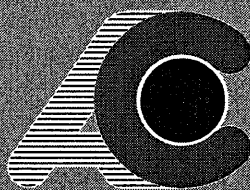

CATTANI S.p.A.

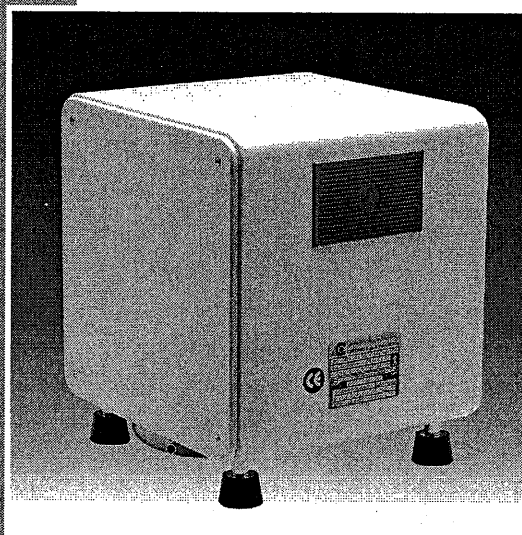

General working data

Dental aspirator

Type: Uni-Jet 75 with box and control panel

Rated tension: 220V + 5%

Rated frequency: 50 Hz

Rated current: 3.1 A







Insulation class: I

Type of appliance: B

Use: continuous service

Protection against humidity: common

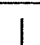
Level of protection against direct or indirect contact type: B 

	Alternating current	IEC 417-5032
	Earthing	IEC 417-5019
	Type B appliance	IEC 878-02-02
	OFF (disconnected from feeding line)	IEC 417-5008
	ON (connected to feeding line)	IEC 417-5007
	Dangerous voltage	IEC 878-03-01

Uni-Jet 75 with box 220 V~ 50 Hz: authorisation



CEI 62-5

N° J 1431

The motor is protected by thermal device

Output power: 0.4 kW

Maximum flow: 1250 l/min

Maximum head for continuous service: 1300 mm H₂O

* Sound pressure 58 dB(A)

Other available voltages:

240 V~ 50 Hz 2.95 A

220 V~ 60 Hz 3.5 A

120 V~ 60 Hz 6.0 A

110 V~ 60 Hz 7.0 A

100 V~ 60 Hz 7.0 A

The appliance cannot work in contact with a flammable anaesthetic mixture with air oxygen or nitrous oxide. A bacteria filter is also available to clean the outflowing air.

*Sound pressure level tested according to the ISO 3746-1979 (E).

Parameters: r=1 - Background noise ≤ 51 dB (A) - Instrument: Brüel & Kjær Type 2232.

Manufactured by Cattani S.p.A. - Parma - Italy



LIST OF COMPONENTS

- | | |
|-----------|--|
| 1 | - ON/OFF switch |
| 2 | - Silencer for exhausted air |
| 3B | - Pipe conveying aspirated air to motor |
| 3C | - Pipe conveying exhausted air outside |

General features

Uni-Jet 75 with box has been created to be combined with the dental unit. It is small in size, noiseless and designed for continuous service.

Installation

Uni-Jet 75 can be placed near the dental unit on the left end of the chair by the patient's feet (fig. A).^{*} Installation must be carried out in conformity with CEI regulations on electromedical appliances; Uni-Jet 75 aspirators have been designed and manufactured according to CEI 62-5/2a 1991.

Prior to plugging in the aspirator, check the ratings and make sure that the mains are suitable for the proper functioning of the appliance and are protected against overcurrent according to CEI 62-8; the appliance must be protected against indirect contacts according to CEI 62-8 and 64-4. Once installation has been completed the unit can be switched on by pressing the main switch to the "ON" position (fig. B).

The switch light will come on; in order to start aspiration lift one of the terminals from its seat. With standard assembly, the aspirated air will be exhausted through silencer 2. In order to convey the air outside you must add an extension to pipe 3 C. Bacteria and most of the noise will be carried outside together with air.

^{*}However, suggested installation is in a storeroom not further than 6-8 metres.

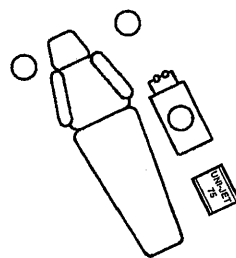

Figure A

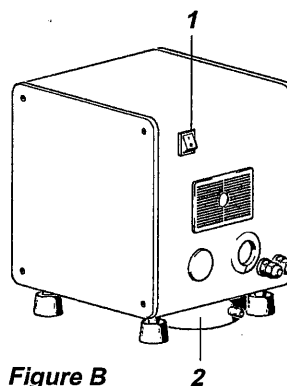

Figure B

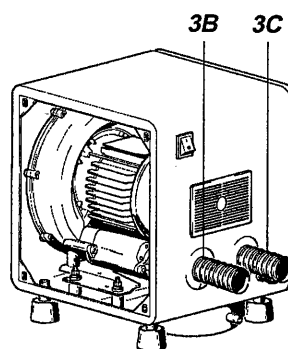

Figure C

Maintenance

The manufacturer is willing to supply spare parts, literature, instruction and any other useful information. Distributors, agents, authorised retailers and service engineers are provided with split-up drawings, electrical diagrams, instructions and updating about maintenance and service.

The appliance is guaranteed for one year from date of sale, provided that guarantee card addressed to manufacturer is returned to the manufacturer reporting date of sale, retailer stamp and customer's name.

Guarantee and manufacturer liability cease in case appliances and/or plants are found tampered by any kind of action performed by unable and thus unauthorised people.

For any use not contemplated or specified in this handbook please refer to manufacturer.

Transport and storage

Packed equipment can be transported and stored within a temperature range of -10 °C to +60 °C.

Packages cannot be exposed to water or splashing and cannot tolerate a humidity level greater than 70%.

Packages can only be stored in piles of three each having the same weight.

UNI-JET 75

ASPIRATORE AD ANELLO D'ARIA
AIR-RING ASPIRATOR

USO AMBULATORIO Ø 30
FOR DENTAL SURGERY D. 30

USO LABORATORIO Ø 40
FOR WORK BENCHES D. 40

LIVELLO DI PRESSIONE SONORA:

- 62 dB (A) aria canalizzata

Normativa: ISO 3746-1979 (E)

Parametri:

- $r = 1$

- Rumore di fondo: <51 dB (A)

- Strumento: Brüel & Kjær Type 2232

Esiste la possibilità di un ulteriore abbassamento di livello sonoro con l'applicazione di silenziatori supplementari.

SOUND PRESSURE LEVEL:

- 62 dB (A) air in channel

Standard ISO 3746-1979 (E)

Parameters:



- $r = 1$

- Background noise: <51 dB (A)

- Control device: Brüel & Kjær Type 2232

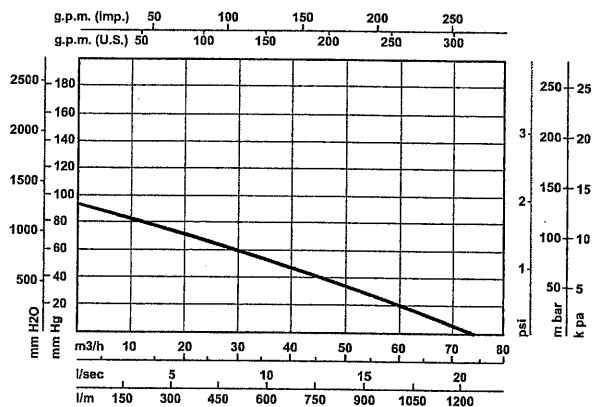
Supplementary sylencers can further reduce the sound level.



Monofase Single phase	Cod. Art. Item No.	V	Hz	Kw	øD	Codice ricambi Spare parts item No.		
						A	B	C
 Usa Ambulatorio For Dental Surgery	020322	220~	50	0.4	ø30	169906	167752	189105
	020324	240~	50	0.4	ø30	169906	167752	189101
	020330	220~	60	0.4	ø30	169907	167764	189101
	020340	110~	60	0.5	ø30	169907	167765	189144
 Usa Laboratorio For Work Benches	020323	220~	50	0.4	ø40	169906	167752	189105
	020325	240~	50	0.4	ø40	169906	167752	189101
	020331	220~	60	0.4	ø40	169907	167764	189101

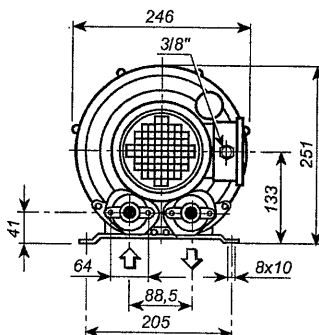
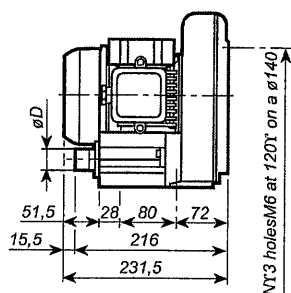
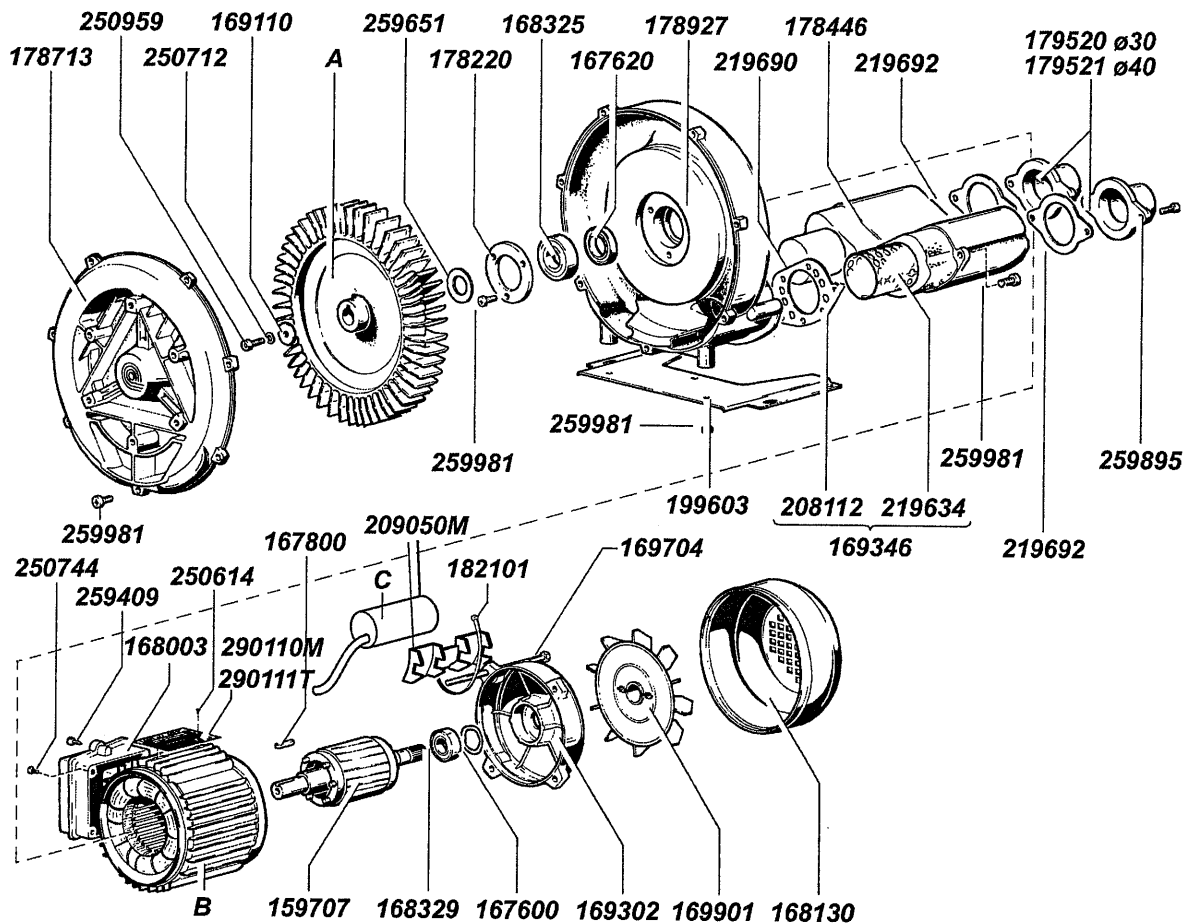

ED.CA. 960315

 **CATTANI S.p.A.**

43100 PARMA - ITALY - Via G. Natta 6/A
Telef. 0521/607604 - Telefax 0521/607628

NY DISEGNO: **015**

ITALIAN PATENTS OR PATENT APPLICATIONS:

1201707 - 1234267 - 1234828 - 1259318 - 1.187.187 - 1253460 - 0766008 - 1236271 - 01242921

FOREIGN PATENTS OR PATENT APPLICATIONS:

EP 0040181 - AU 546.143 - US 4,386,910 - EP 0 638 295 - EP 0 254 687 - AU 590433 - US 4,787,846 - US 5,039,405
- EP 0335061 - US 5,002,486 - EP 0211808 - AU 580839 - US 4,684,345 - EP 0 557 251 - US 5,330,641 - EP 0766008
- US 4,710,209

PENDING PATENT

IT M093U000019 - EP 0 749 728 - IT M095U000030 - JP 168553/97 - IT M097A000139 - IT M098A000019 - IT M098A000119

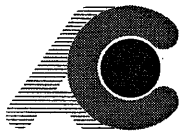

CATTANI S.p.A.

Via G. Natta, 6/A - 43100 Parma (Italy) - Tel. 0521 607604 - Telefax 0521 607628-607855

<http://www.cattani.it> Email: cattani@tin.it

Azienda con Sistema Qualità Certificato secondo UNI EN ISO 9001 - UNI CEI EN 46001



ESAM S.p.A.

Via G. Natta, 4/A - 43100 Parma (Italy) - Tel. 0521 607613 - Telefax 0521 607628-607855

<http://www.esam.it> Email: esamspa@tin.it

Azienda con Sistema Qualità Certificato secondo UNI EN ISO 9002



Ed. APR. 98

HOME